

NOTES:
 The projected density for the Warner Valley area are based off the Washington City General Plan.
 The density range is from 0.5 to 4.5 units per acre for a total of 12,401 dwelling units.
 Below is the land use and density for the South Mountain project:

| RESIDENTIAL Single and Multi-Family | | COMMERCIAL | |
|---|-----------|-------------------------------|-----------|
| Du/Ac* | Area* | VILLAGE CENTER | 58.5 AC. |
| Medium Density 5-8 Du/Ac 73.1 AC. | | VILLAGE 15 | 12.0 AC. |
| VILLAGE 1 | 32.6 AC. | VILLAGE 16 | 9.3 AC. |
| VILLAGE 2 | 18.0 AC. | VILLAGE 17 | 10.1 AC. |
| VILLAGE 3 | 22.47 AC. | VILLAGE 18 | 11.6 AC. |
| Low Density 3-4.5 Du/Ac 97.7 AC. | | VILLAGE 19 | 15.5 AC. |
| VILLAGE 5 | 30.63 AC. | VILLAGE 7 (Possible) | |
| VILLAGE 6 | 18.8 AC. | SEMI-PUBLIC USE | |
| VILLAGE 7 (Possible Comm.) | 29.7 AC. | CHURCH | |
| VILLAGE 11 | 18.56 AC. | VILLAGE 20 | 3.5 AC. |
| Very Low Density 1.5-2.5 Du/Ac 84.9 AC. | | RECREATION CENTER | |
| VILLAGE 4 | 18.82 AC. | VILLAGE 21 | 6.6 AC. |
| VILLAGE 8 | 25.52 AC. | OPEN SPACE | |
| VILLAGE 9 | 26.0 AC. | PARK | 16.3 AC. |
| VILLAGE 10 | 14.6 AC. | VILLAGE 22 | 9.9 AC. |
| Medium High Density 7-12 Du/Ac 114.9 AC. | | VILLAGE 23 | 7.4 AC. |
| VILLAGE 12 | 46.16 AC. | BALL FIELDS | |
| VILLAGE 13 | 27.4 AC. | VILLAGE 24 | 16.34 AC. |
| VILLAGE 14 | 41.3 AC. | COMMON OPEN SPACE | 126.9 AC. |
| ALL RESIDENTIAL 370.6 AC. | | LAKES | 25.4 AC. |
| RIGHTS-OF-WAY | | ALL OPEN SPACE 185 AC. | |
| MAJOR STREETS 58.6 AC. | | | |
| TOTAL PROJECT AREA: 616.7 AC. | | | |

*NOTE: All Areas are approximate, and all counts are estimates.

PROJECT BOUNDARY
 FLIGHT APPROACH ZONE

ACCESS VIA S. 300 EAST

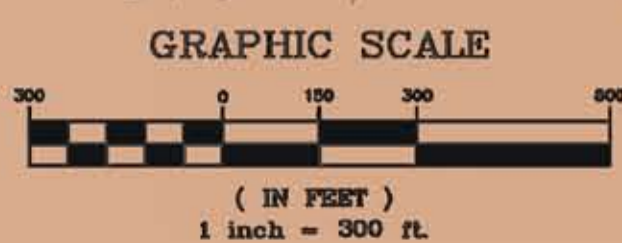
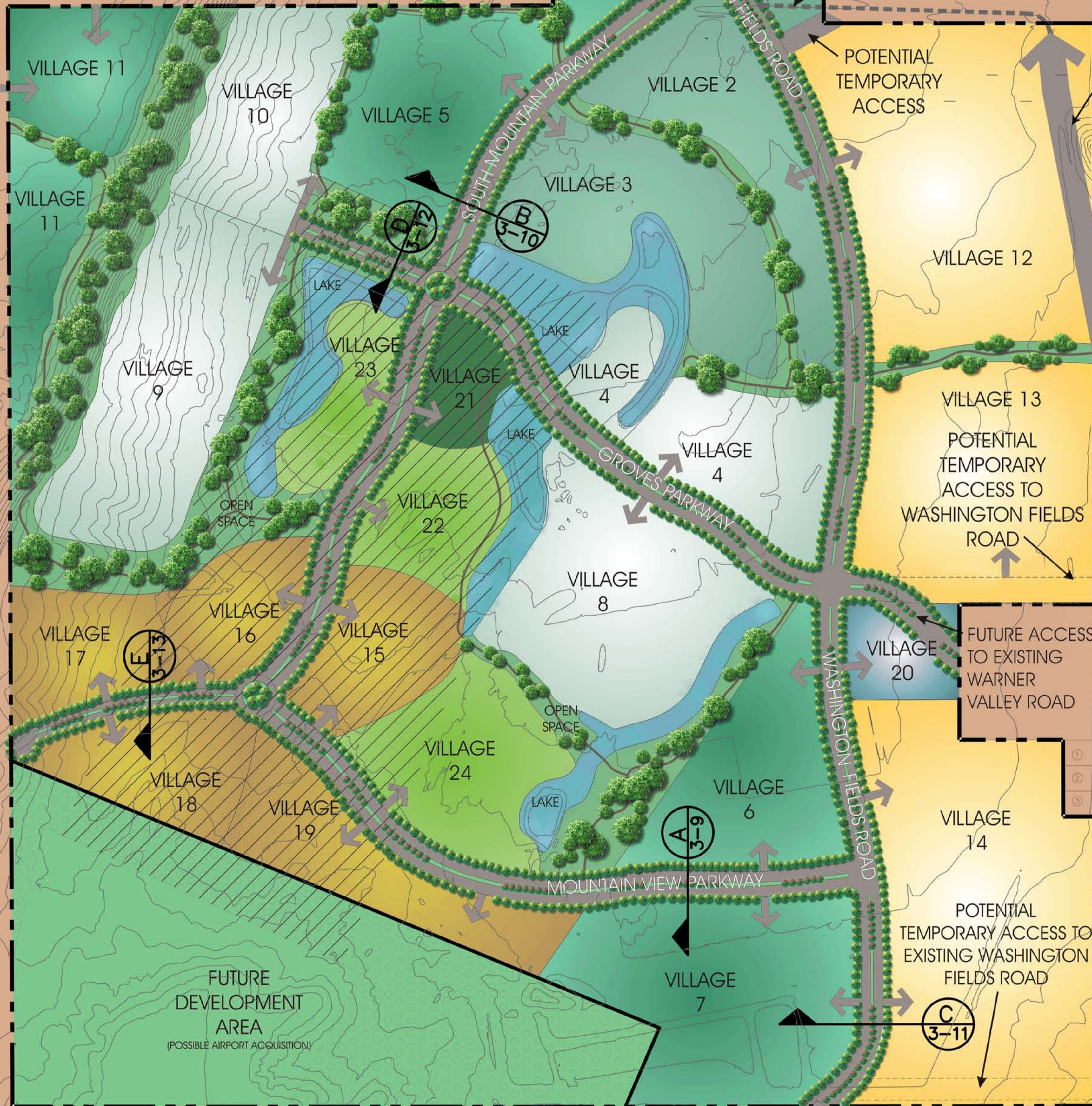

SOUTH MOUNTAIN

A MASTER PLANNED COMMUNITY
 WASHINGTON CITY, UTAH

Sunrise Ridge Development LLC
 619 South Bluff Street, Tower 2
 St. George, UT 84770

